

Installation instructions for HARO Cork Floor with Top Connect

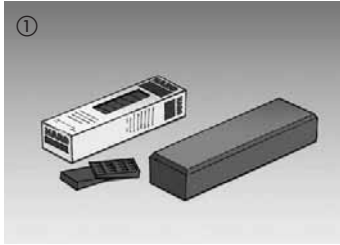

Attention: Read thoroughly from beginning to end before installation!

Please always comply with the installation instructions that are enclosed with the cartons. The accompanying instructions are binding!



Installation tools: Tapping block, pencil, saw

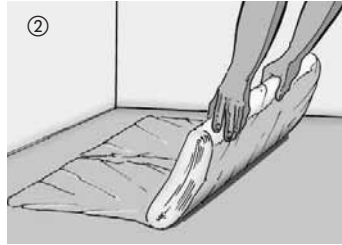

Always use 0.2 mm thick PE film overlapped by 30 cm as an underlay when laying your floor over floor screed. This should overlap in the 30 cm impact area. Extend underlay up all walls. After having installed the skirtings cut underlay at the upper edge of the skirtings. **As the HARO cork floor already has an integrated cork insulation layer, do not use any additional insulation underlay.**

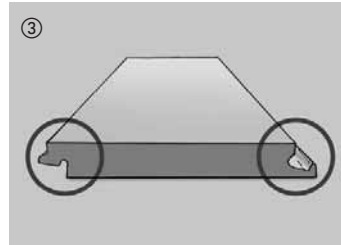

Tongue side / Groove side

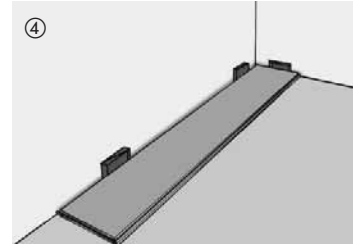

Starting in the right-hand corner of the room, align the boards of the first row with the tongue side parallel to the wall, and fix them in place with wall spacers as you proceed (always keep an expansion gap of 10–15 mm (3/8" – 1/2") around perimeter).

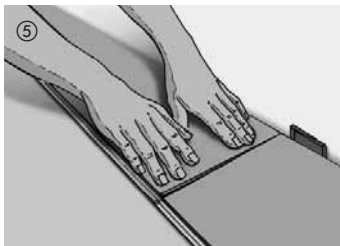

The remaining boards of the first row must be clicked in from above at the head ends into the previous boards. Pressure applied briefly to the side joint clicks in the board into the adjacent board. It is important to ensure that the first row is straight and exactly parallel to the wall. Cut the last board of the first row to size, leaving an expansion gap of 10–15 mm (3/8" – 1/2") between the board and wall. Fit in the board and lay it flat.



The next row is started with the leftover piece of the first row (short side offset of at least 40 cm). This considerably reduces waste. The rest of the installation is performed board-by-board. First, the boards are angled into the previous row along the long side by applying a small amount of force.

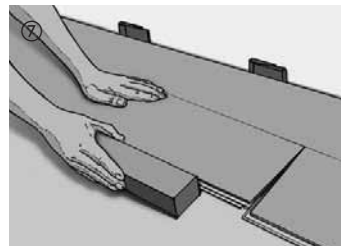

Tap edge gently with tapping block, if necessary.

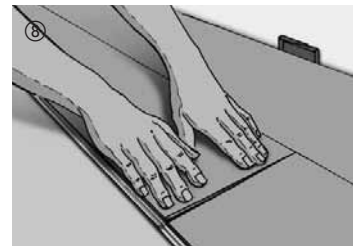

The board is then lowered in on the short side. Ensure here that the board is flush at the short side with the previously laid board. Pressure applied briefly to the side joint clicks in the board.

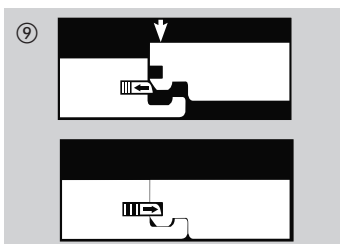

Short side profile Interlocking

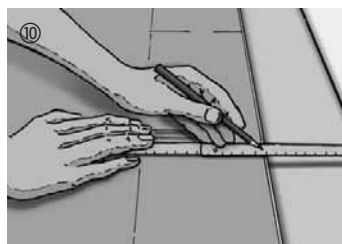

Cut to size and fit in the boards of the last row. Leave a gap of 10 to 15 mm between the boards and wall.

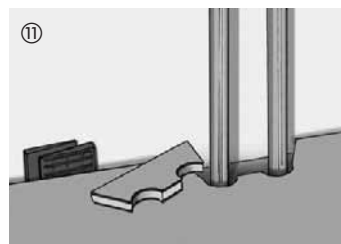

If radiator pipes protrude from the floor, drill or saw a cutout into the board (the size of the cutout depends on the radiator pipe and the required expansion space).

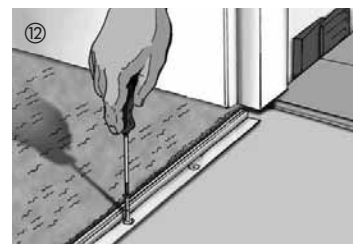

In doorways, mount a suitable moulding system to ensure the necessary expansion space. This also applies if the same floor is to be laid in the adjoining room. In this case, a transition moulding should be used for covering the required expansion gap.

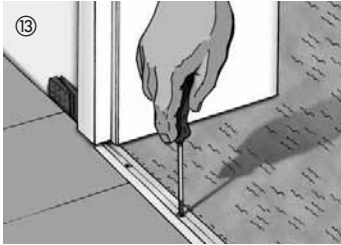

Leave an expansion space of approx. 5 mm between the board and the base of the moulding. As a rule, a fine saw must be used to cut a gap the thickness of a board in wooden door frames to allow the cork floor to expand. Be sure to remove all distance spacers once all boards are laid. Fasten skirtings (with or without clip system) to the walls – that's it.

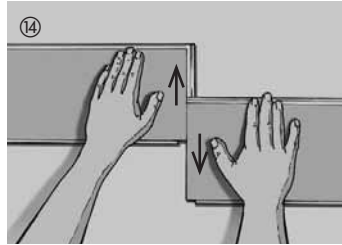

To unlock the boards, you can slide them in parallel.

General information

Attention: Read thoroughly from beginning to end before installation!



Measures to take before installation

Do not open the cartons prior to installation. Store and climatise the unopened cartons inside. New constructions to be closed in with air conditioning or heating units during the winter months. Recommended room conditions for installation are 18 °C (65 °F).

Important: Prior to installation, inspect the boards in daylight for any visible faults or damage and also check colour and texture. No claims are accepted once flooring boards have been installed. Elastic and textile floor coverings must be completely removed leaving no remains.

When installing, mix Korkett boards from different cartons to compensate for material-related colour variations.

Installation direction

The direction of laying normally depends on the main source of light fall in the room, e.g. French windows. The boards should run parallel with the entering light for best appearance. However, the proportions of the room can also be emphasised by skilled selection of the direction in which your parquet is laid. Light-colours make small rooms appear larger. With floating installation in large areas over 10 m (33 ft.) in length or width, an expansion joint must be allowed for. Apply an expansion moulding or cover strip over said expansion joint.

- Ensure that the boards are always laid lengthways in narrow hallways.
- When installing T, L or U-shaped areas, separate the flooring areas according to the room layout by using a suitable profile system.

Moisture check

The subfloor must be checked for moisture by using e.g. a CM measuring instrument.

Moisture content limit

Cement screed max. 2.0 % CM, with underfloor heating 1.8 % CM; anhydride screed max. 0.5 % CM, with underfloor heating 0.3 % CM. When laying parquet flooring over newly installed concrete screed or cast plaster subfloors – after a curing time of at least 6 to 8 weeks – or over underfloor heating, always use 0.2 mm (8 mils) PE film as an underlayment for additional moisture protection. Overlap seams with 30 cm (12 ") and tape. When laying your floor in rooms on or below grade, it is necessary that a state-of-the-art or DIN-compliant moisture barrier be installed.

Installation over underfloor heating

When installing your floor over underfloor heating, the screed must be laid in accordance with the German DIN 1853 standard. Before you start the installation, please verify that the underfloor heating system has been installed in compliance with DIN EN 1264 Part 1-4 and that the proper preparatory heat-up phase has been completed once the professional installers have been coordinated. Detailed instructions on the installation over underfloor heating can be obtained from your HARO dealer.

Care

Detailed instructions on care can be found in the HARO Floor Care Guide which you can obtain from your dealer.

Dry cleaning: It is usually sufficient to clean your HARO Cork Floor dry using a dust mop, soft broom or vacuum cleaner.

Damp cleaning/Care: We recommend damp mopping your floor surface regularly with HARO Polish or clean & green natural diluted in water. Cleaning frequency depends here on the wear and tear your floor is subjected to.

Intensive cleaning: To remove major soiling and ingrained dirt, you can use clean & green active for intensive cleaning. Treat the floor with clean & green natural after each basic cleaning.

Please note: Always wring out the cloth or mop very well before wiping the floor. Do not wet mop the parquet surface and never leave puddles or standing water! Steam cleaning machines are not suitable for cleaning cork flooring.

Indoor climate conditions

What is good for people is also good for your Cork Floor. At a room temperature of 20° C (68 °F), a relative humidity of about 50–60 % is an ideal indoor climate. In order to keep the air humidity constant, especially during hot periods, we recommend you use a humidifier. This will prevent any extreme drying out of the floor. Air humidifiers should be switched on right from the beginning of the heating season. If air humidity falls below normal values, small gaps may appear, which generally close again after the heating period.

Additional preventive protection

To preserve the quality and beauty of your floor we recommend using Teflon furniture glides (PTFE) under chairs and furniture legs and doormats in entrances. Chair castors and office roller chairs must comply with German Standard DIN 12529. Use only lined rollers of type W (soft). It is also a good idea to use polycarbonate mats as underlay for armchairs and office chairs.

09/15 Subject to modification in the interest of technical development.