

# Installation instructions for DISANO Classic

**Attention: Read thoroughly from beginning to end before installation!**

**Please always comply with the installation instructions that are enclosed with the cartons. The accompanying instructions are binding!**

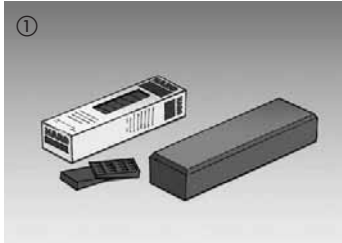

Installation tools: Tapping block, pencil, saw.



Always use 0.2 mm thick PE film overlapped by 30 cm as an underlay when laying your floor over floor screed. This should overlap in the 30 cm impact area. Extend underlay up all walls. After having installed the skirtings cut underlay at the upper edge of the skirtings. As the floor already has an integrated cork insulation layer, do not use any additional insulation underlay.

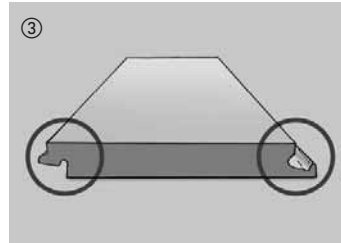

Tongue side / Groove side

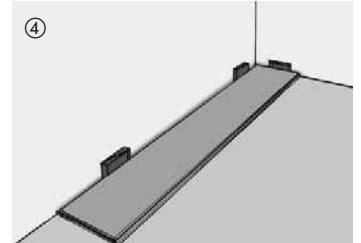

Starting in the right-hand corner of the room, align the boards of the first row with the tongue side parallel to the wall, and fix them in place with wall spacers as you proceed (always keep an expansion gap of 10–15 mm (3/8" – 1/2") around perimeter).

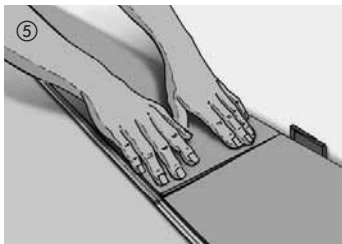

The remaining boards of the first row must be clicked in from above at the head ends into the previous boards. Pressure applied briefly to the side joint clicks in the board into the adjacent board. It is important to ensure that the first row is straight and exactly parallel to the wall. Cut the last board of the first row to size, leaving an expansion gap of 10–15 mm (3/8" – 1/2") between the board and wall. Fit in the board and lay it flat.



The next row is started with the leftover piece of the first row (short side offset of at least 50 cm). This considerably reduces waste. The rest of the installation is performed board-by-board. First, the boards are angled into the previous row along the long side by applying a small amount of force.

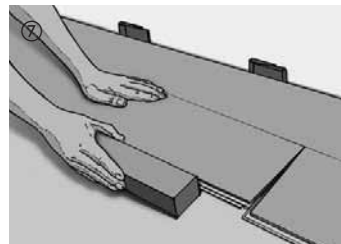

Tap edge gently with tapping block, if necessary.

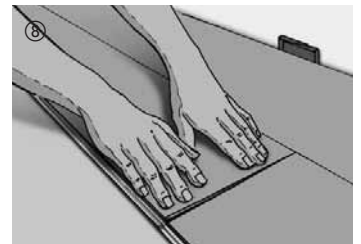

The board is then lowered in on the short side. Ensure here that the board is flush at the short side with the previously laid board. Pressure applied briefly to the side joint clicks in the board.

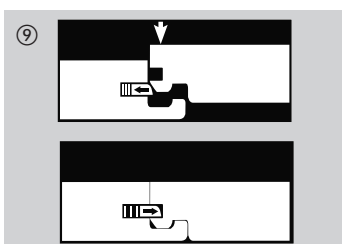

Short side profile Interlocking

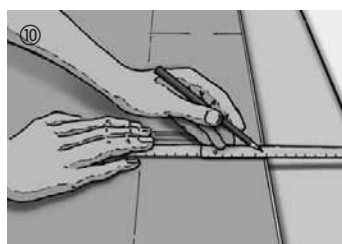

Cut to size and fit in the boards of the last row. Leave a gap of 10 to 15 mm between the boards and wall.

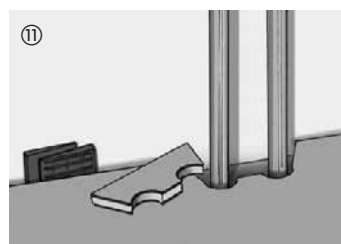

If radiator pipes protrude from the floor, drill or saw a cutout into the board (the size of the cutout depends on the radiator pipe and the required expansion space).

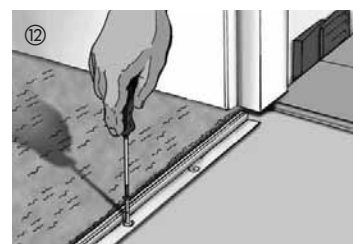

In doorways, mount a suitable moulding system to ensure the necessary expansion space. This also applies if the same floor is to be laid in the adjoining room. In this case, a transition moulding should be used for covering the required expansion gap.

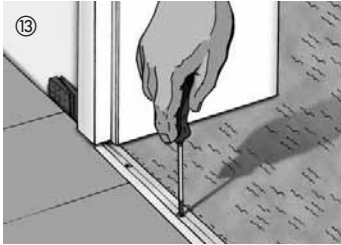

Leave an expansion space of approx. 5 mm between the board and the base of the moulding. As a rule, a fine saw must be used to cut a gap the thickness of a board in wooden door frames to allow DISANO Classic to expand. Be sure to remove all distance spacers once all boards are laid. Fasten skirtings (with or without clip system) to the walls – that's it.

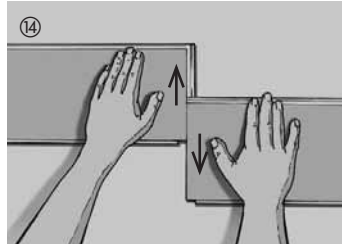

Tip for unlocking: The boards can be pushed out from one another parallel.

# General information

Attention: Read thoroughly from beginning to end before installation!

## Measures to take before installation

Do not open the cartons prior to installation. Store and climatise the unopened cartons inside. New constructions to be closed in with air conditioning or heating units during the winter months. Recommended room conditions for installation are 18 °C (65 °F).

**Important: Prior to installation, inspect the boards in daylight for any visible faults or damage and also check colour and texture. No claims are accepted once flooring boards have been installed. Elastic and textile floor coverings must be completely removed leaving no remains.**

## Installation direction

The direction of laying normally depends on the main source of light fall in the room, e.g. French windows. The boards should run parallel with the entering light for best appearance. However, the proportions of the room can also be emphasised by skilled selection of the direction in which your parquet is laid. Light-coloured designs make small rooms appear larger. With floating installation in large areas over 10 m (33 ft.) in length or width, an expansion joint must be allowed for. Apply an expansion moulding or cover strip over said expansion joint.

- Ensure that the boards are always laid lengthways in narrow hallways.
- When installing T, L or U-shaped areas, separate the flooring areas according to the room layout by using a suitable profile system.

**Preparing the subfloor:** The subfloor must be level, dry and solid; the respective DINs must be compiled with. Cement screed, mastic asphalt, V100 particle boards, old floor coverings, such as ceramic or low-pile glued down carpets, for example, are suitable.

## Moisture check

The subfloor must be checked for moisture by using e.g. a CM measuring instrument.

## Moisture content limit

Cement screed max. 2.0 % CM, with underfloor heating 1.8 % CM; anhydride screed max. 0.5 % CM, with underfloor heating 0.3 % CM. When laying parquet flooring over newly installed concrete screed or cast plaster subfloors – after a curing time of at least 6 to 8 weeks – or over underfloor heating, always use 0.2 mm (8 mils) PE film as an underlayment for additional moisture protection. Overlap seams with 30 cm (12 ") and tape. When laying your floor in rooms on or below grade, it is necessary that a state-of-the-art or DIN-compliant moisture barrier be installed.

## Installation over underfloor heating

When installing your floor over underfloor heating, the screed must be laid in accordance with the German DIN 1853 standard. Before you start installing the floor, please verify that the

underfloor heating system has been installed in compliance with DIN EN 1264 Part 1-4 and that the proper preparatory heat-up phase has been completed once the parties involved have been coordinated. Detailed information and instructions are available from your local authorised dealer. Compliance with indoor climate conditions must in particular be ensured with underfloor heating.

## Care

**Dry cleaning/marks:** It is generally sufficient to clean DISANO Classic dry using a mop, soft broom or vacuum cleaner. Any rubber marks from shoe soles or grease marks can be removed with ethanol. Spilt oil should be removed immediately from the floor because of the higher risk of slipping. The longer period effect of aggressive solvents, such as acetone or disinfectants, can cause surface changes. Such substances must be removed immediately from the DISANO surface.

**Initial cleaning/damp mopping:** We recommend initial cleaning and damp mopping your floor surface regularly with clean & green natural diluted in water. Cleaning frequency depends here on the wear and tear your floor is subjected to.

**Intensive cleaning:** To remove major soiling and ingrained dirt, you can use clean & green active for intensive cleaning. Treat the floor with clean & green natural after each basic cleaning.

**Please note: Do not use soap-based detergents, abrasive cleaners, scouring powder, aggressive solutions, steel wool, wax or polish for cleaning and maintenance. Always avoid letting water stand on the DISANO by HARO surface. Steam cleaning machines are not suitable for cleaning the floor.**

## Indoor climate conditions

What is good for people is also good for your floor. At a room temperature of 20° C (68 °F), a relative humidity of about 30–60 % is felt to be pleasant. In order to keep the air humidity constant, especially during hot periods, we recommend you use a humidifier. This will prevent any extreme drying out of the floor. Air humidifiers should be switched on right from the beginning of the heating season. If air humidity falls below normal values, small gaps may appear, which generally close again after the heating period.

## Additional preventive protection

To preserve the quality and beauty of your floor we recommend using Teflon furniture glides (PTFE) under chairs and furniture legs and doormats in entrances. Chair castors and office roller chairs must comply with German Standard DIN 12529. Use only lined rollers of type W (soft). For additional protection, we recommend placing protective HARO mats under armchairs and office chairs.

01/16 Subject to modification in the interest of technical development.