

General information

Attention: Read thoroughly from beginning to end before installation!



Installation tools: HARO Distance spacers or plastic spacers, pencil, saw. Always use 0,2 mm thick PE film overlapped by 30 cm as an underlayment when laying your floor over concrete screed or cast plaster subfloors or over underfloor heating. Extend underlay up all walls. After having installed the skirtings cut underlay at the upper edge of the skirtings.



For sound insulation and to smooth out slight irregularities of the subfloor, unroll 2 mm thick cork underlay. Do not overlap. Our range of accessories also offers alternative insulation underlays. Asphalt-bitumen felt is not suitable for sound insulation.

Do not use any additional insulation underlay when laying HARO TRITTY Silent Pro.

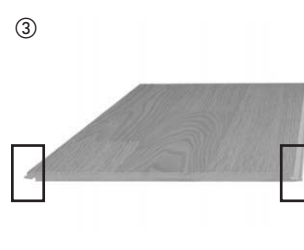

tongue side / groove side



Starting in the right-hand corner of the room, align the boards of the first row with the tongue side parallel to the wall, and fix them in place with distance spacers or plastic spacers as you proceed (always keep an expansion gap of 10-15 mm (3/8"-1/2") around perimeter).

The installation can be done by complete row (7 – 8) as well as by each individual board (9 – 11)

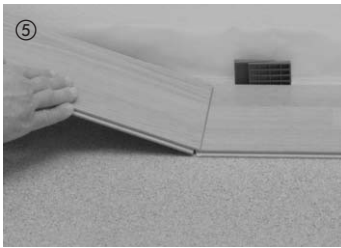

To assemble the first row, insert the end of each board at a slight angle into the mating end of the already installed board at its right. Then rotate the board downward to interlock.

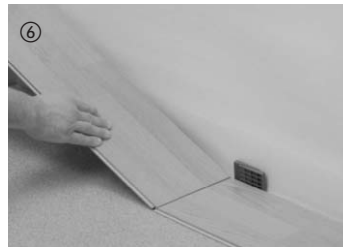

Cut the last board of the first row to size, leaving an expansion gap of 10-15 mm (3/8"-1/2") between the board and wall. Fit in the board at a slight angle and lay it flat. Start the second row with the leftover piece from the first row. Make sure to offset the end joints of adjoining rows by at least 40 cm (20"). This considerably reduces waste.

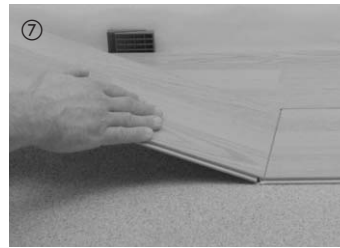

Installation by complete row:

Align the boards of the next row with the tongues of their long sides resting on the lower groove cheeks of the previous row. Now connect the boards of the second row at the short sides first.



Beginning in the right-hand corner of the room, lightly raise the whole second board row and rotate this row downward to interlock it with the previous one.



Board by board installation:

The remaining rows should be installed board by board. The board should be first angled into the short side of the previous board in the same row.



The board is then pushed into the previous row by applying a small amount of force along the long side of the board.



Subsequently, you close the joint by applying a small amount of force with the heel of your hand near the short-end jointing.



If radiator pipes protrude from the floor, drill or saw a cutout into the board (the size of the cutout depends on the radiator pipe and the required expansion space).

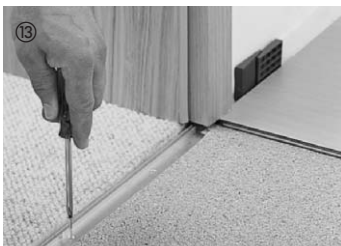

In doorways, mount a suitable moulding system to ensure the necessary expansion space. This also applies if the same floor is to be laid in the adjoining room. Leave an expansion space of approx. 5 mm between the board and the base section of the moulding. As a rule, a fine saw must be used to cut a gap the thickness of a board in wooden door frames to allow the laminate floor to expand.



Cut to size and fit in the boards of the last row. Leave a gap of 10 to 15 mm between the boards and wall.



Remove all distance spacers and make sure that all expansion spacers are free. Fasten skirtings (with or without clip system) to the walls – that's it.

General information

Attention: Read thoroughly from beginning to end before installation!

Measures to take before installation

Do not open the cartons prior to installation. Store and climatize the unopened cartons inside. New construction to be closed in with air conditioning or heating units during the winter months. Recommended room conditions for installation are 18°C (65 °F).

Important: Prior to installation, inspect the boards in daylight for any visible faults or damage and also check colour and structure. No claims are accepted once flooring boards have been installed.

Installation direction

The direction of laying normally depends on the main source of light fall in the room, e.g. French windows. The boards should run parallel with the entering light for best appearance. However, the proportions of the room can also be emphasized by skilled selection of the direction in which HARO is laid. Light-coloured wood makes small rooms appear larger.

In doorway and large areas over 10 m (33 ft.) in length and/or width an expansion joint must be allowed for long or wide. Apply an expansion moulding or cover strip over said expansion joint.

- Ensure that the boards are always laid lengthways in narrow hallways.
- When installing T-, L- or U-shaped areas, separate the flooring area according to the room layout by using a proper profile system.

Moisture check

The subfloor must be checked for moisture by using e.g. a CM measuring instrument.

Limit moisture content

Cement screed max. 2.0 CM-mass-%, underfloor heating 1.8 % CM, anhydride screed max. 0.5% CM-mass-%, underfloor heating 0.3 % CM. When laying your HARO floor over newly installed concrete screed or cast plaster subfloors - after a curing time of at least 6 to 8 weeks - or over underfloor heating, always use 0.2 mm (8 mils) thick PE film as an underlay for additional moisture protection. Overlap seams with 30 cm (12") and tape. When laying your HARO floor in rooms on or below grade, it is necessary that a state-of-the-art or DIN-compliant moisture barrier be installed.

Installation over underfloor heating

When your HARO floor is to be installed over underfloor heating, the screed must be laid professionally as per German Standard DIN 18353. Please ensure prior to installation that the underfloor heating system has been laid in accordance with the DIN EN 1264 and DIN 4725 standards and that the heat-up record has been complied with to prepare the subfloor for laying the floor covering. Detailed instructions on the installation over underfloor heating can be obtained from your HARO dealer.

Care

Detailed instructions on care can be found in the HARO Floor Care Guide.

First care: Immediately after laying your new floor, you carry out first treatment with HARO Secura-A. HARO Secura-A significantly reduces the absorption of water during damp mopping and protects the seams and surface against moisture. To ensure a long lifetime of your floor, we recommend routine treatment with HARO Secura-A once a year for intensive care.

Dry cleaning: It is usually absolutely sufficient to clean HARO TRITTY dry using a mop, soft broom or vacuum cleaner. For especially effective dry cleaning we recommend our special HARO Easy Clean cleaning cloth. Heel streaks or grease stains can be removed with HARO Stain Remover or acetone.

Damp cleaning: We recommend damp mopping your surface regularly with HARO Laminate Floor Cleaner. The frequency hereby depends on the wear and tear your floor is subjected to. Add about 150 ml (5 fl.oz.) of HARO Laminate Floor Cleaner to 8-10 litres (2-2.5 gal) of water and wipe the floor with a well-wrung cloth. By buffing the treated surface dry with

a HARO Polishing Cloth you give your laminate flooring surface an even shine.

Please note: Do not use soap-based detergents, abrasive cleaners, scouring powder, steel wool, wax or polish for cleaning and caring for your HARO Laminate Floor. Always wring out the cloth or mop very well before wiping the floor. Do not wet mop the laminate flooring surface and never leave puddles or standing water! Steam cleaning machines are not suitable for cleaning laminate flooring.

Room climate

What is good for people is also good for the high-grade woods of HARO TRITTY. At a room temperature of 20°C (68°F), a relative humidity of about 50–60% is felt to be pleasant. During the heating season, this figure is often fallen below to a considerable extent. To prevent the wood from drying out, which may cause the development of smaller gaps between the flooring elements, it is advisable to use an humidifier (evaporator), right from the beginning of the heating season.

Preventive protection

To preserve the quality and beauty of your HARO TRITTY Laminate Floor we recommend using protective pads under chairs and furniture legs. Place quality walk-off mats at entrances, garages or basements to minimise tracked-in dirt, grit and moisture. Chair castors and office roller chairs must comply with German Standard DIN 68131. Use only lined rollers of type W (soft). It is also a good idea to use polycarbonate mats (from our range of accessories) for additional protection.

01/04 Subject to modification in the interest of technical development.